



NUMBER: B400R1036-A

DATE: AUGUST 17, 1990

SUPERSEDES: B400R1036-0

SERVICE BULLETIN

Effective Serial Number: All Units

Ride: GIANT GONDOLA WHEEL

Subject: Inspection of Torque
Tube Fasteners

Service Bulletin Number B400R1036-0 has been superseded by this Service Bulletin and is no longer in effect. All copies of Service Bulletin B400R1036-0 should be destroyed.

The torque tube to tower head joint on the GIANT GONDOLA WHEEL amusement ride was designed with sufficient clamping force being achieved when each of the bolts in the joint is torqued from a 700 minimum to 850 maximum foot pounds. Chance Rides, Inc. requires all owner/operators of GIANT GONDOLA WHEELS to use a torque wrench to verify that the proper torque has been applied to each of these bolts at every set up or once each operating season, whichever occurs first.

A new decal, reflecting this 700 to 850 foot pound range, is now available. When replacing the old decal, the new one should be placed directly over the old one. Refer to the installation instruction on the reverse side of this bulletin.

All work must be performed by qualified personnel, capable of understanding the function of the parts and their proper installation. If there are any questions regarding this bulletin or the instructions contained in it, contact the CHANCE RIDES, INC. CUSTOMER SERVICE DEPARTMENT.

Item No	Part Number	Description	QTY. Req'd.
1.	277-2192901	DECAL - Capscrew Tightening (400-341-001)	... 2
2.	277-2192902	DECAL - Capscrew Inspection (400-342-001)	... 2

INSTALLATION INSTRUCTIONS

1. Install one of decal (Item #1) on each bearing housing as shown, so that it is visible with the tower legs DOWN. Apply the new decal directly over the top of the old decal.

A WARNING A

TIGHTEN THE CAPSCREWS FOR THE TORQUE TUBE TO 700-850 FT-LBS. BEFORE ERECTING THE TOWER LEGS. FAILURE TO DO SO CAN CAUSE STRUCTURAL FAILURE AND RESULT IN SERIOUS INJURY TO PASSENGERS AND/OR BYSTANDERS.

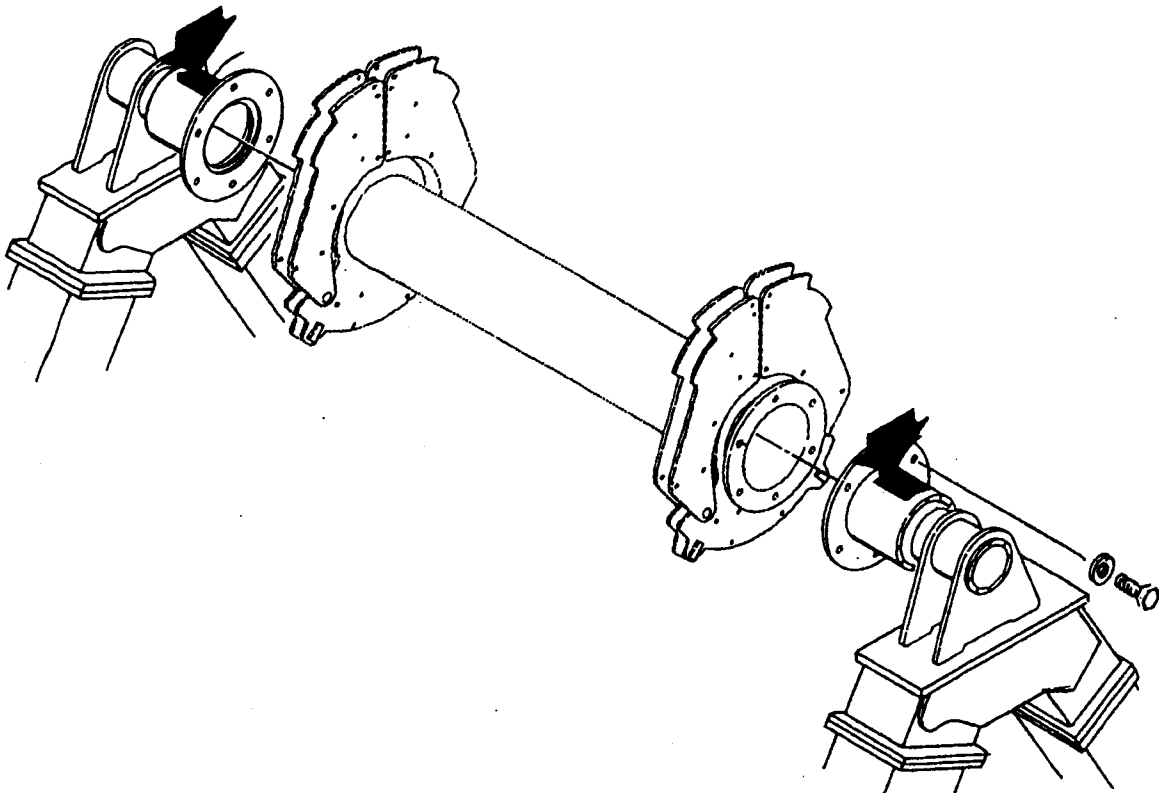

2. Install one decal (Item #2) on each tower leg as shown, so that it is easily visible by maintenance and inspection personnel. Apply the new decal directly over the top of the old decal.

A WARNING A

THE CAPSCREWS FOR THE TORQUE TUBE MUST BE TIGHT (700-850 FT-LBS.) TO PREVENT STRUCTURAL FAILURE AND SERIOUS INJURY TO PASSENGERS AND/OR BYSTANDERS.

CHECK THE CAPSCREWS WITH A TORQUE WRENCH ONCE EACH SEASON OR AT EVERY SET-UP, WHICHEVER OCCURS FIRST.

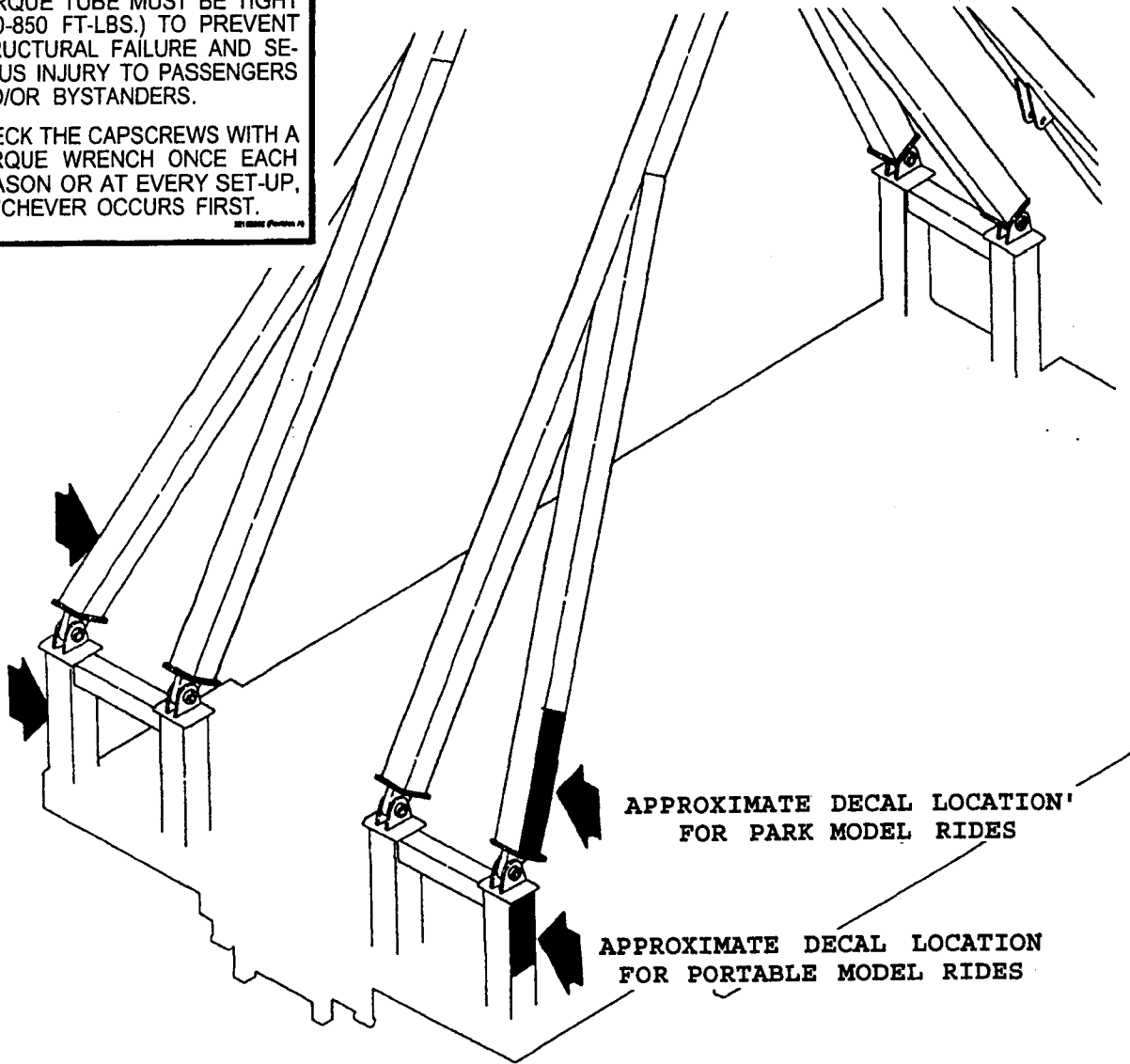

APPROXIMATE DECAL LOCATION FOR PARK MODEL RIDES

APPROXIMATE DECAL LOCATION FOR PORTABLE MODEL RIDES